

# 3-Port IEEE-1394b Hub

## FWB-HUB-3PORT

- **Three 800Mb/s IEEE-1394b locking ports**
- **Compact industrial grade metal case**
- **Locking connections for 1394b cables**
- **Multiple mounting options**

The FirePRO™ 3-port IEEE-1394b hub, designed and manufactured by Point Grey Research, supports the simultaneous connection of multiple 1394b FireWire devices. It is a reliable and cost effective solution for creating up to a 63 node FireWire system, extending devices beyond the standard 4.5m cable length, or supplying external power to the 1394 network.

The compact 51x67x21mm metal case minimizes the risk of physical damage and is ideal for applications where space is limited. The hub's design incorporates locking 9-pin 1394b bilingual ports, multiple mounting points, and an external power connector to ensure a secure physical connection and stable network configuration.

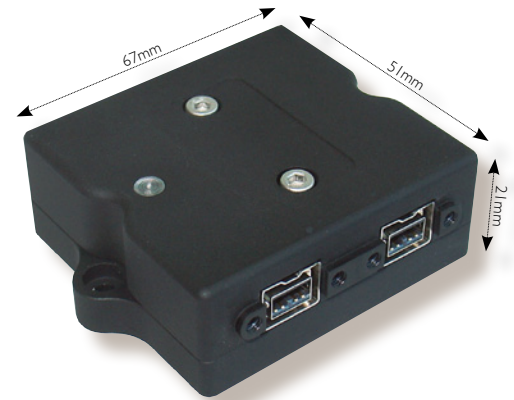

Part Number  
FWB-HUB-3PORT

## FIREPRO™

### COMPATIBILITY

- All Point Grey 1394 camera products
- All Point Grey FirePRO™ products

### DIMENSIONS

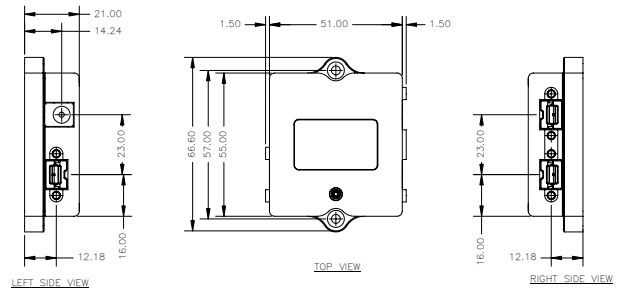

### FEATURES

- Three (3) bilingual 9-pin 1394b 800Mb/s (S800) ports
- 100, 200, 400 and 800Mb/s transfer rates
- Supports IEEE P1394b revision 1.20 at 1Gb signaling rates
- Backward compatible with 1394-1995 and 1394a-2000
- Fully interoperable with Firewire™ and i.LINK™
- Front and rear mounting options prevent hub movement
- Port protection minimizes ESD effects and PHY errors
- External power input, standard barrel connector
- Status LED to indicate power and device connection
- Supports Plug and Play and hot swapping

### General Specifications

Dimensions	51 x 67 x 21mm (WxDxH)
Mass	TBA
Power input/output	8-32V / 1A output per port at 12V
Power consumption	Max 0.5W at 12V
Chipset	TI TSB81BA3E physical layer
Compliance	RoHS, FCC Class B, CE
Mounting	Front / rear, M3x4mm screw holes
Operating temperature	0°C to 45°C
Storage temperature	-30°C to 60°C
Warranty	2 years

### LED Status Light

Off	Not receiving power
Green	Receiving power but not connected to a device
Orange	At least one port is connected to a device

### SAMPLE CONFIGURATION

